

## LCD Flat Panel Articulating Wall Mount For 10" to 22" LCD Flat Panel Screens

### NEW!

The Peerless LCD Flat Panel Articulating Wall Mount provides a cost-effective mounting solution for 10" to 22" LCD flat panel screens. Extremely flexible, this mount folds flat against the wall to a slim 1.8" depth or extends out up to 14.46". Its silver finish elegantly complements offices, conference rooms, merchandising displays, hotel rooms or any room in the home. This two-link arm provides easy, one-touch tilt and up to 180 degrees of swivel for optimal screen positioning. The LCS-KLA comes completely pre-assembled for a fast and easy installation.

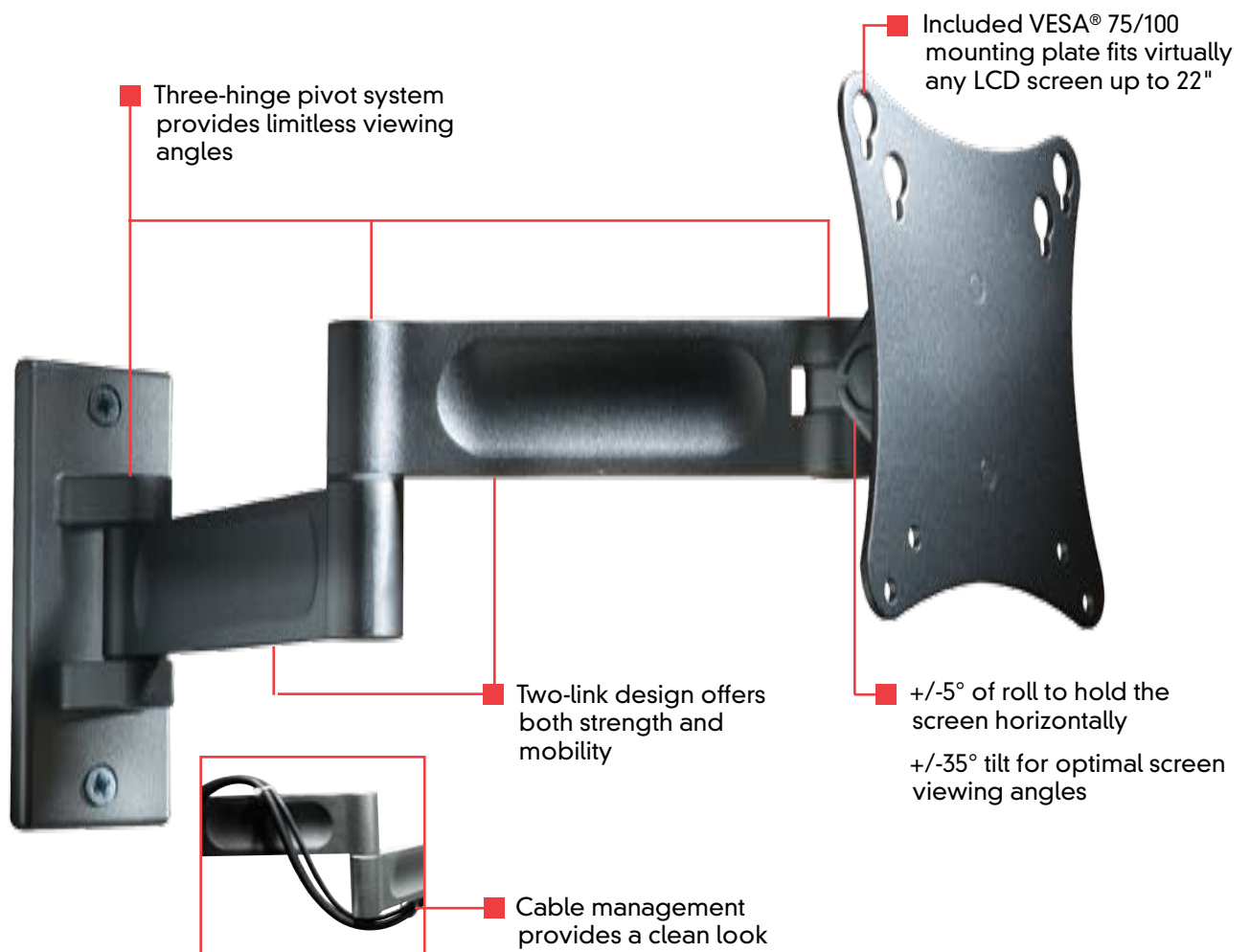



# LCD Flat Panel Articulating Wall Mount

## For 10" to 22" LCD Flat Panel Screens

**Model Numbers**  
LCS-KLA

### Product Specifications

- For 10"-22" LCD flat panel screens up to 25 lb
- Fits VESA® 75/100 mounting hole patterns
- Cable management provides a clean look
- +/-5° roll for screen leveling
- Extends from the wall up to 14.46"
- Folds flat to hold screen only 1.8" from the wall
- Adjustable pivot points provide tension control
- Extensive tilt range of ±35°
- Screen swivels up to 180°
- All necessary hardware included
- Pre-assembled for quick installation

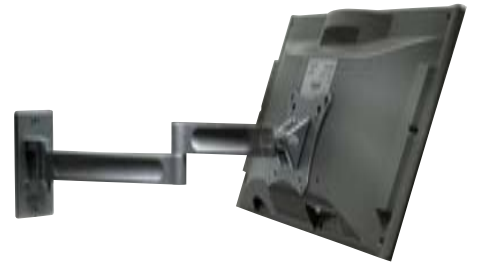

### FEATURES

**DIMENSIONS (W x H x D)** 14.46" x 5.5" x 1.8" (36.72 x 13.97 x 4.5 cm)

**LOAD CAPACITY** UL listed to 25 lb (11.3 kg)

**PRODUCT WEIGHT** 1.9 lb (.86 kg)

**FINISH** Scratch resistant fused epoxy

**AVAILABLE COLORS** Silver

**ACCESSORIES** Metal Stud Accessory Kit (ACC908)  
Accessory Security Fasteners (ACC918)

### Package Specifications

Monitor arm assembly with VESA 75/100 screen adapter plate, mounting and screen attachment hardware

**UNITS IN PACKAGE** 1

**PACKAGE SIZE (W x H x D)** 10.43" x 7.18" x 2.5" (26.49 x 18.23 x 6.35 cm)

**PACKAGE SHIP WEIGHT** 2.65 lb (1.2 kg)

**PACKAGE UPC CODE** LCS-KLA: 735029240198

**WARRANTY** Limited 5-year



+/-35° tilt for optimal screen viewing angles



Cable management provides a clean look



Peerless Industries, Inc.  
3215 W. North Avenue,  
Melrose Park, IL 60160

(800) 865-2112  
(708) 865-8870  
Fax: (708) 865-2941  
www.peerlessmounts.com